

NO	DESCRIPTION OF REVISIONS	MADE BY	DATE
1	RE-ISSUE	L. LOPEZ	2/02
2	ADDED DURABLE TAPE NOTE.	L. LOPEZ	6/03
3	REVISED NOTE #1		
4			

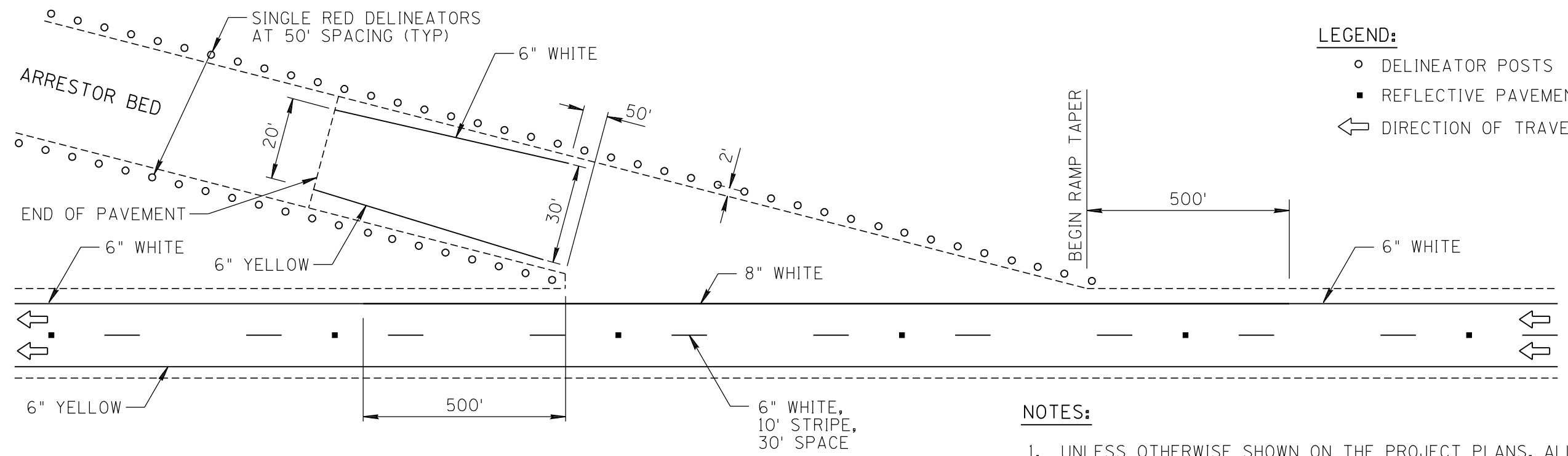

- LEGEND:**
- DELINEATOR POSTS
 - REFLECTIVE PAVEMENT MARKER
 - ← DIRECTION OF TRAVEL

- NOTES:**
1. UNLESS OTHERWISE SHOWN ON THE PROJECT PLANS, ALL FREEWAY MARKINGS STATEWIDE SHALL USE DURABLE TAPE FOR LANE LINES, EXIT GOES AND HOV LANE SYMBOLS. WHEN USED ABOVE ELEVATIONS OF 4,000 FT., DURABLE TAPE SHALL BE INSTALLED IN A GROOVE PER TAPE MANUFACTURER'S RECOMMENDATIONS.
 2. STRIPING PLAN MAY BE MODIFIED TO FIT EXISTING CONDITIONS.

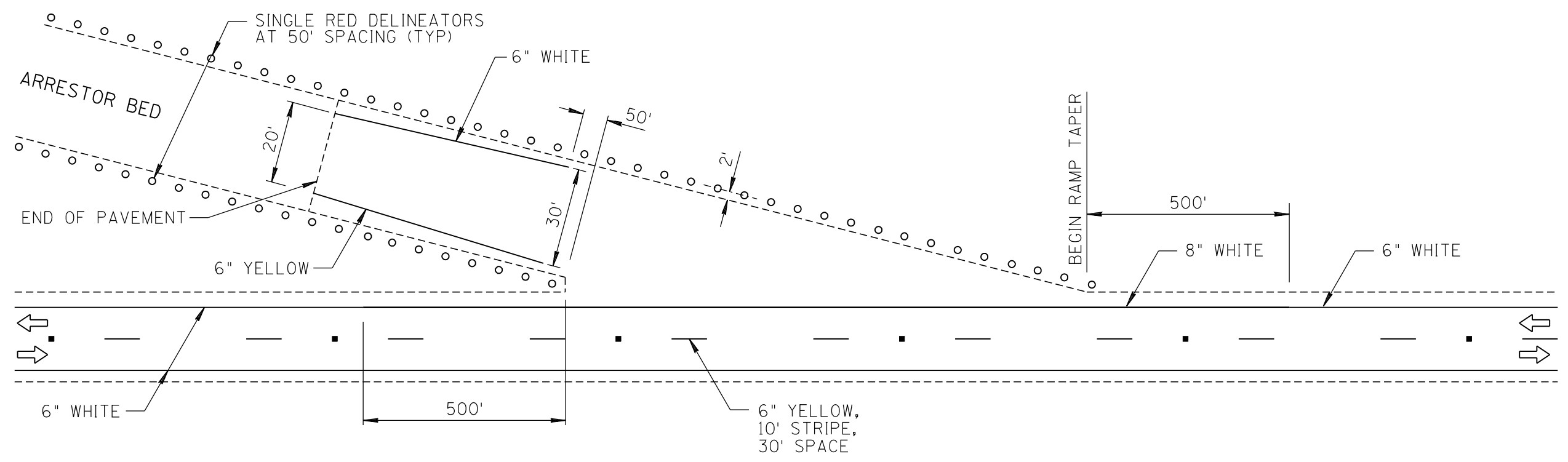

MULTI-LANE DIVIDED

TWO-LANE TWO-WAY

NOT TO SCALE

DESIGN APPROVED	ARIZONA DEPARTMENT OF TRANSPORTATION INTERMODAL TRANSPORTATION DIVISION TRAFFIC SIGNING & MARKING STANDARD DRAWINGS	REVISION	1/10
SIGNATURES		DRAWING NO.	M-14
APPROVED FOR DISTRIBUTION	STRIPING AND DELINEATION FOR TRUCK ESCAPE RAMPS	SHEET NO.	1 OF 1
ON FILE			