

GILA COUNTY

PINAL COUNTY

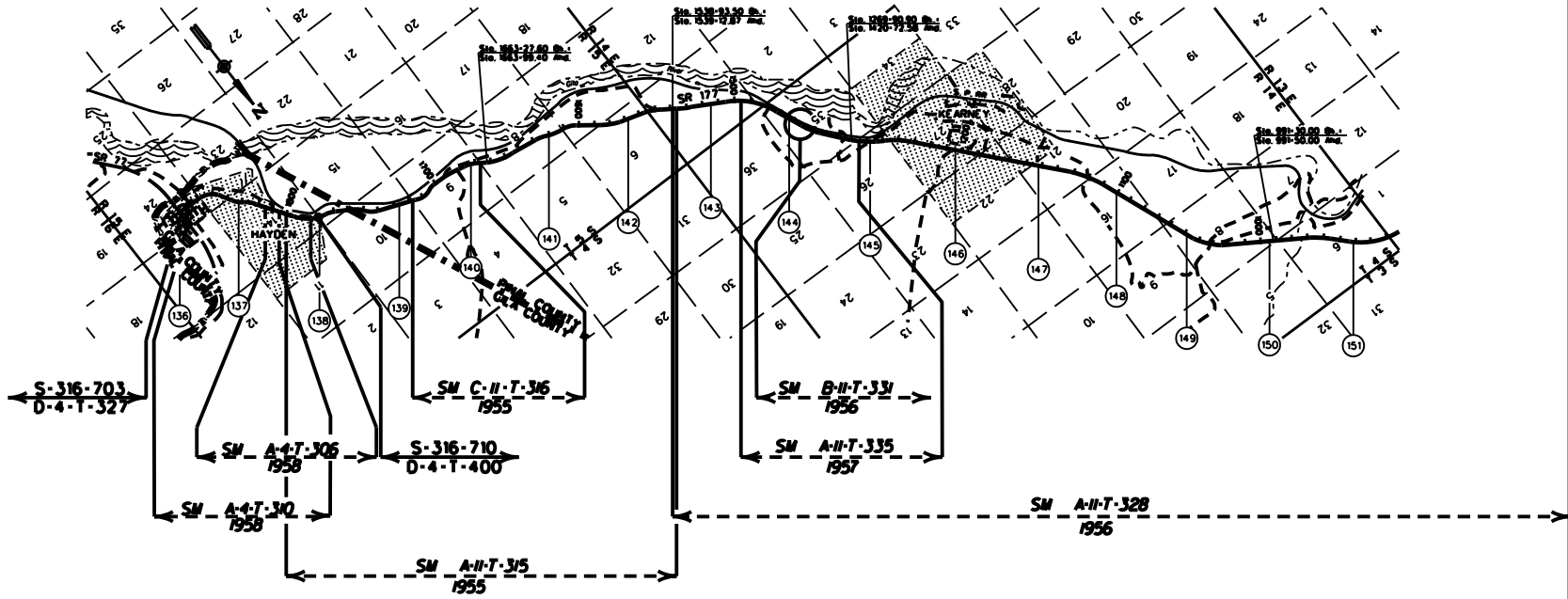

<p>LEGEND</p> <p> HIGHWAY MILEPOST STATIONING TICKS STRIP MAP SHEET MAP </p>	<p>ARIZONA DEPARTMENT OF TRANSPORTATION INTERMODAL TRANSPORTATION DIVISION RIGHT OF WAY SECTION</p>		<p>1</p>
	<p>MILEPOST MAP</p>		
	<p>ROUTE SR 177</p>	<p>MILEPOST 136.21 - 181.00</p>	
<p>WINKELMAN - SUPERIOR HWY</p>			

COPIES OF RIGHT OF WAY MAP SHEETS AND STRIP MAPS ARE AVAILABLE TO THE PUBLIC FROM: RIGHT OF WAY PLANS SECTION, MAIL DROP 612C, 205 SOUTH 17TH AVENUE, PHOENIX AZ 85007, TELEPHONE (602)712-7270.

